

Building Directory

- Bone & Joint Center**Bldg. 9
1725 N. 5TH ST. | Indiana Orthopedic Institute, Orthopedic Surgery, Podiatry, Hand | Phone (812) 242-3005
Outpatient Therapy | Phone (812) 238-7210
- Bone & Joint South**4601 S. 7th St.
Sports Medicine, Orthopedic Walk-In Clinic | Phone (812) 242-3005
- Brain & Spine Center**Bldg. 3
1513 N. 6 1/2 St. | Interventional Pain Management | Phone (812) 231-4797, Neurosurgery | Phone (812) 242-3125
- Cardiac Rehab Cath Lab**Bldg. 2
Union Hospital West, 8th Ave Entrance | Phone (812) 238-7000
- Center for Occupational Health**4001 Wabash Ave.
Professional Plaza | Phone (812) 238-7788
- Downtown Clinic | Convenient Care**221 S. 6th St.
Family Medicine | Phone (812) 242-3120, Pediatrics | Phone (812) 242-3105, Psychiatry/Psychology | Phone (812) 244-5058, Convenient Care | Phone (812) 242-3737
- Eastside Clinic**2149 SR 46
Family Medicine, Dermatology, Convenient Care | Phone (812) 244-1800
- Poplar Medical Center**422 Poplar St.
Eye Center (Ophthalmology), Diabetes Clinic, Diabetes Education and Outpatient Nutrition | Phone (812) 242-3700
- Heart & Vascular Institute**Bldg. 2
Union Hospital West, 8th Ave Entrance | Phone (812) 238-4908
- Hux Center**Bldg. 4
1711 N. 6 1/2 St., Clara Fairbanks | Phone (812) 238-7766, Oncology & Hematology | Phone (812) 242-3610, Radiation | Phone (812) 238-7504, Rheumatology | Phone (812) 244-5097
- Illiana North**Bldg. 7
1332 N. 7th St., Phone (812) 478-8888
- Illiana South**601 Surgery Center Dr.
Phone (812) 235-1200
- Landsbaum Center for Health Education**1433 N. 6 1/2 St.
Phone (812) 237-7609
- Medical Office Building**Bldg. 8
1429 N. 6th St. | Allergy, Asthma, Audiology, Cardiology, Ear Nose & Throat, Gastroenterology, General Surgery, OB/GYN, Pulmonology, Urology, Lab Services | Phone (812) 232-0564, Pharmacy | Phone (812) 242-3855
- Northside Clinic**1739 N 4th St.
Center for Better Sleep | Phone (812) 242-1000, Family Medicine | Phone (812) 242-3600,
- One Professional Center**1801 N 6th St
Behavioral Health | Phone (812) 234-6053, EAP | Phone (812) 238-4931
- Pediatric Therapy**450 8th Ave.
Phone (812) 238-7171
- Professional Office Building**Bldg. 5
1530 N. 7th St. | Administration, Fitness Center, Lab Services, Physician Offices, Pulmonary Rehab, Valley Professionals, Remote Patient Monitoring, Family Medicine Residency, Neurology
- Springhill Pediatrics & Pulmonology**4525 S. Springhill Junction St.
Pediatrics & Pulmonology | Phone (812) 234-6053
- Springhill Sleep Center**4551 S. Springhill Junction St.
Phone (812) 235-1453

Campus Map

Terre Haute, IN

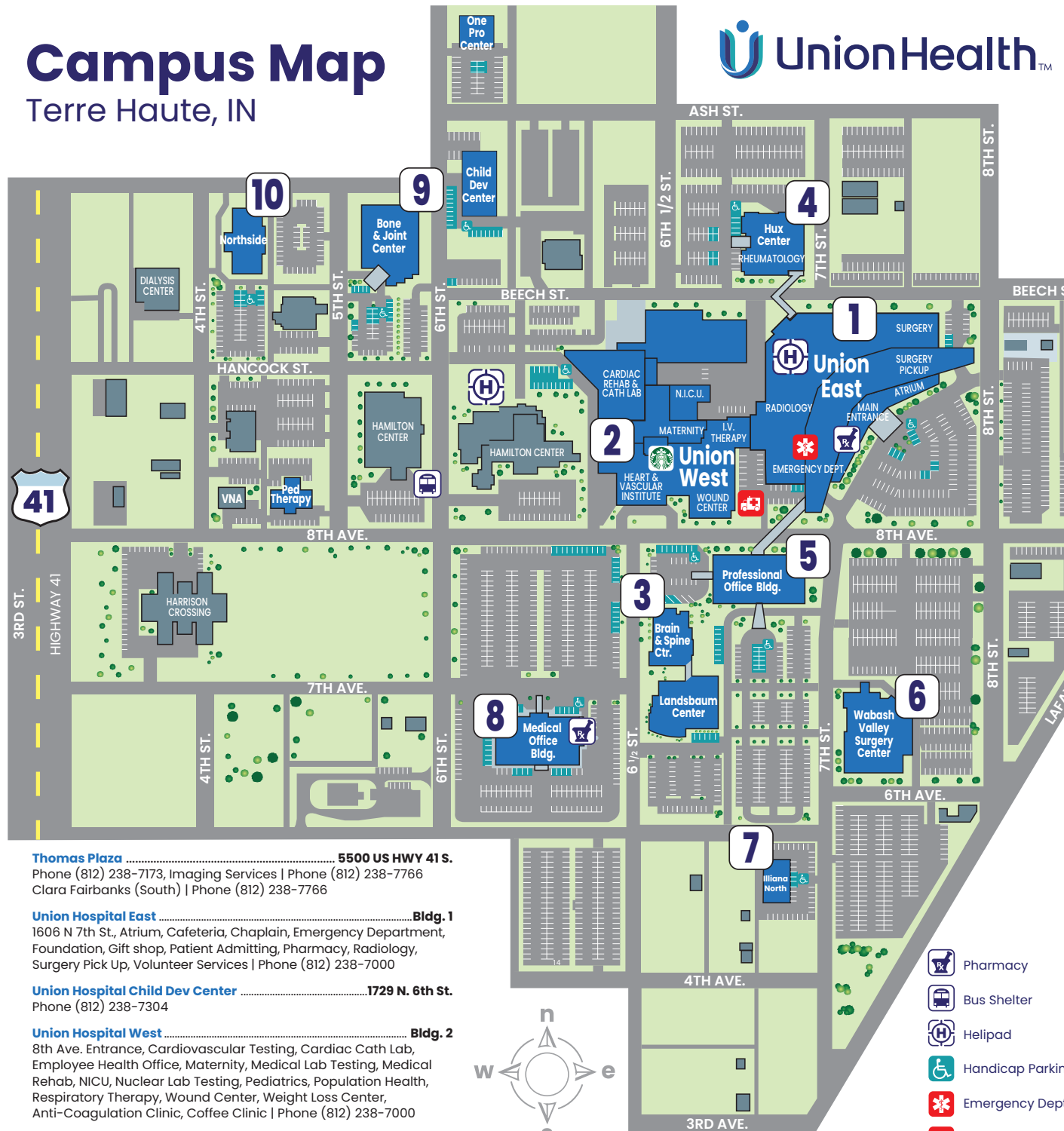

- Thomas Plaza**5500 US HWY 41 S.
Phone (812) 238-7173, Imaging Services | Phone (812) 238-7766
Clara Fairbanks (South) | Phone (812) 238-7766
- Union Hospital East**Bldg. 1
1606 N 7th St., Atrium, Cafeteria, Chaplain, Emergency Department, Foundation, Gift shop, Patient Admitting, Pharmacy, Radiology, Surgery Pick Up, Volunteer Services | Phone (812) 238-7000
- Union Hospital Child Dev Center**1729 N. 6th St.
Phone (812) 238-7304
- Union Hospital West**Bldg. 2
8th Ave. Entrance, Cardiovascular Testing, Cardiac Cath Lab, Employee Health Office, Maternity, Medical Lab Testing, Medical Rehab, NICU, Nuclear Lab Testing, Pediatrics, Population Health, Respiratory Therapy, Wound Center, Weight Loss Center, Anti-Coagulation Clinic, Coffee Clinic | Phone (812) 238-7000
- Wabash Valley Surgery Center**Bldg. 6
1421 N 7th St | Phone (812) 232-7192

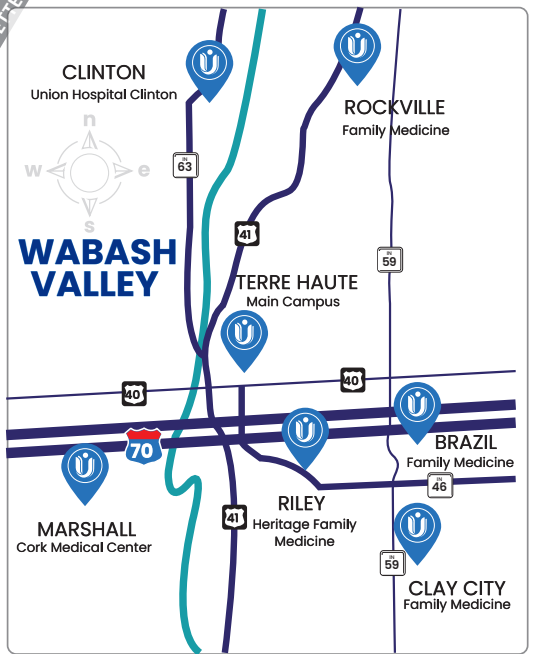
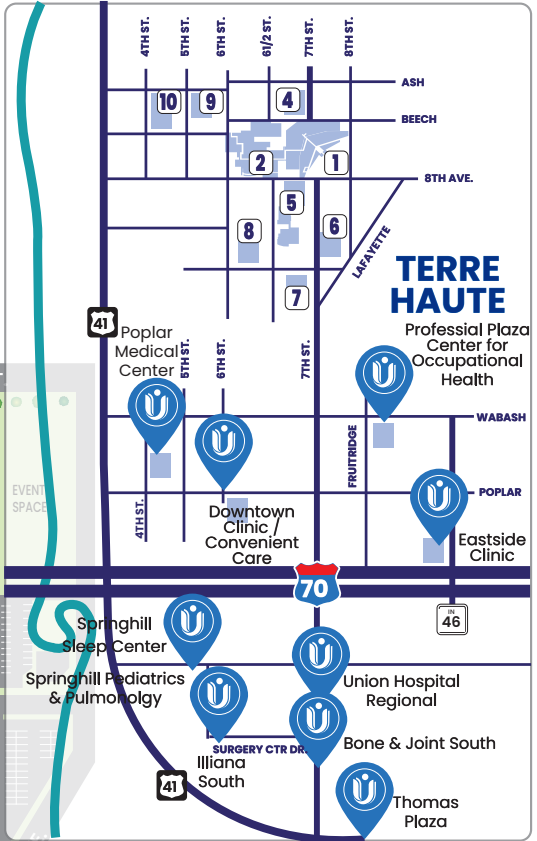
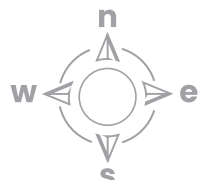

- Pharmacy
- Bus Shelter
- Helipad
- Handicap Parking
- Emergency Dept.
- Emergency Entr.

Main Buildings Floor Map

Department Location

Admitting – Union Hospital West	1st floor West
Admitting – Union Hospital East	1st floor East
Anticoagulation Clinic	1st Floor West
Atrium Classrooms A/B	Lower Level East
Atrium Conference Room East	Lower Level East
Clinical Resource Center	Lower Level East
Gray Room	Lower Level West
Cafeteria	Lower Level East
Cardiac Rehab	1st Floor West
Cardiovascular Testing	1st Floor West
Cath Lab Admitting	1st Floor West
Chapel	Lower Level East
Chaplain's Office	Lower Level East
Continuing Medical Ed (C.M.E.)	Lower Level East
Dining	Lower Level East
Emergency Department (E.R.) Check-In	1st Floor East
Foundation	Lower Level East
Gift Shops	Lower Level East, 1st Floor West
Green Room	Lower Level West
Critical Care Unit	2nd Floor East
Lab	Lower Level West
Labor Delivery & OB Emergency	1st Floor West
Mother/Baby	3rd Floor West
Neonatal Intensive Care Unit (N.I.C.U.)	1st Floor West
Nuclear Medicine	1st Floor East
Pediatrics	3rd Floor West
Pharmacy (Lobby)	1st Floor East
Physicians Dining	Lower Level East
Radiology	1st Floor East
Respiratory	2nd Floor East
Starbucks Coffee Clinic	1st Floor West
Surgery	1st Floor East
Surgery Hostess	1st Floor East
Surgical Patient Rooms	3rd Floor East
Telemetry Inpatient	2nd Floor East
Telemetry Outpatient	2nd Floor West
Volunteer Services	Lower Level East
Wound Healing Center	1st Floor West

SCAN HERE



TO ACCESS GOOGLE MAPS



Main Campus
Terre Haute, IN 47804

Legend

- Elevators
- Waiting
- Restrooms
- Stairs
- Pharmacy
- Information
- PEDWAYS
- WEST BLDG. 2
- EAST BLDG. 1

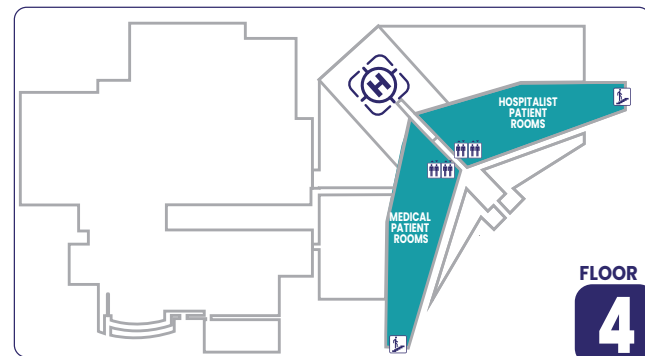
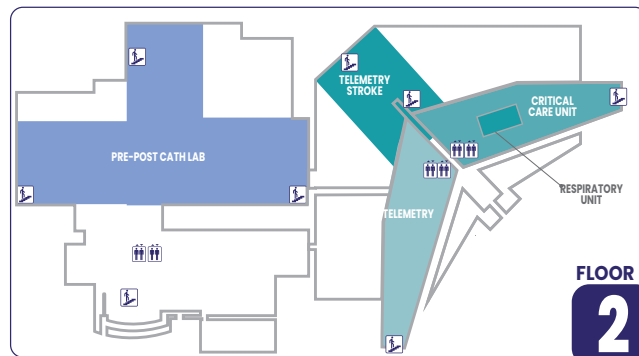
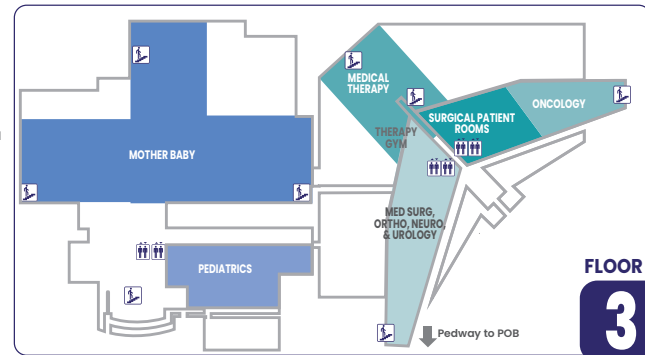
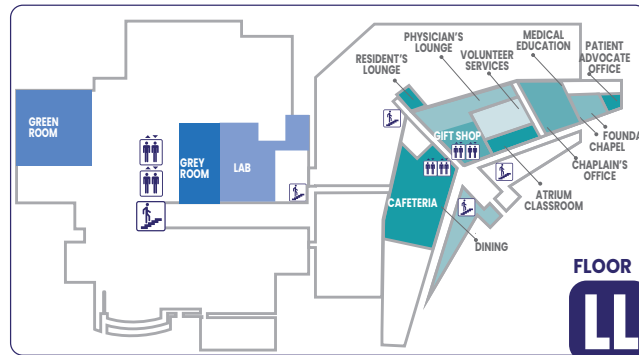
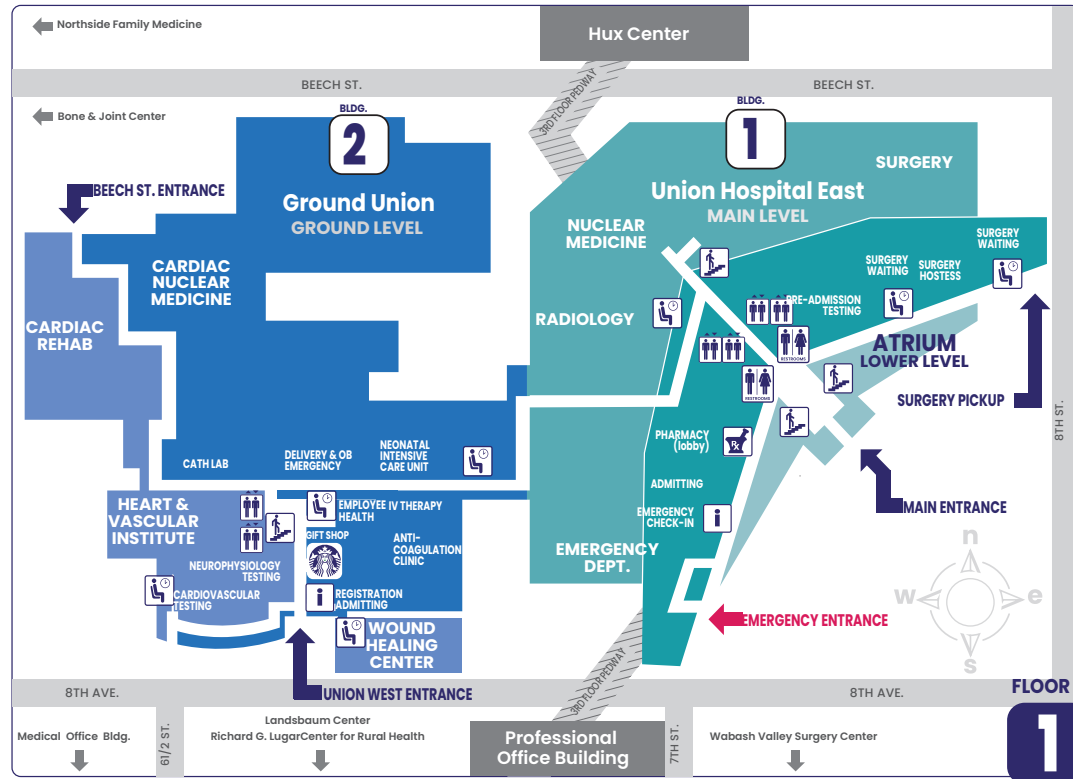

2025

CAMPUS MAP

Main Campus | Terre Haute, IN

To learn more about our quality services visit www.union.health

